

A man and a woman are on a boat, smiling and looking towards the sunset. The man is wearing a striped shirt and sunglasses, and the woman is wearing a straw hat and sunglasses. The background is a deep blue sea under a warm, golden light.

CAPE HAYAT

A CURATED COLLECTION BY RAK PROPERTIES

RAK PROPERTIES

An aerial photograph capturing a vast, lush green mangrove forest. A prominent, winding waterway cuts through the dense vegetation, reflecting the soft light of the sky. In the background, a city skyline is visible, featuring several tall buildings, including a pair of distinctive, slender towers. Beyond the city, a range of mountains stretches across the horizon under a clear, light sky. The overall scene conveys a sense of natural beauty and urban development coexisting.

AN
EVOLVING
EMIRATE



Nestled between the mountains of Jebel Jais and the wide open ocean, Ras Al Khaimah, a vibrant UAE emirate is packed with natural beauty, culture and heritage. Over the years, it has become a prominent destination.



ENHANCING LIVES & PLACES

As we move towards an exciting future for Ras Al Khaimah, we have made it our mission to be the most respected lifestyle developer building communities that embody the spirit of Ras Al Khaimah. Our flagship projects like Julphar Towers and Mina Al Arab confirm the standing of RAK Properties as one of the prime property developers in the Emirate.

URBAN ISLAND LIVING

We all aspire to a beautiful life, by the ocean. With golden sands at our feet and sea breeze in our hair. Welcome to Mina Al Arab, an extraordinary urban island destination in the heart of Ras Al Khaimah, that combines the best of urban living with the tranquillity of island life. It has been carefully designed to provide a sustainable and inspiring environment where residents and visitors can indulge in remarkable experiences and create lasting memories.

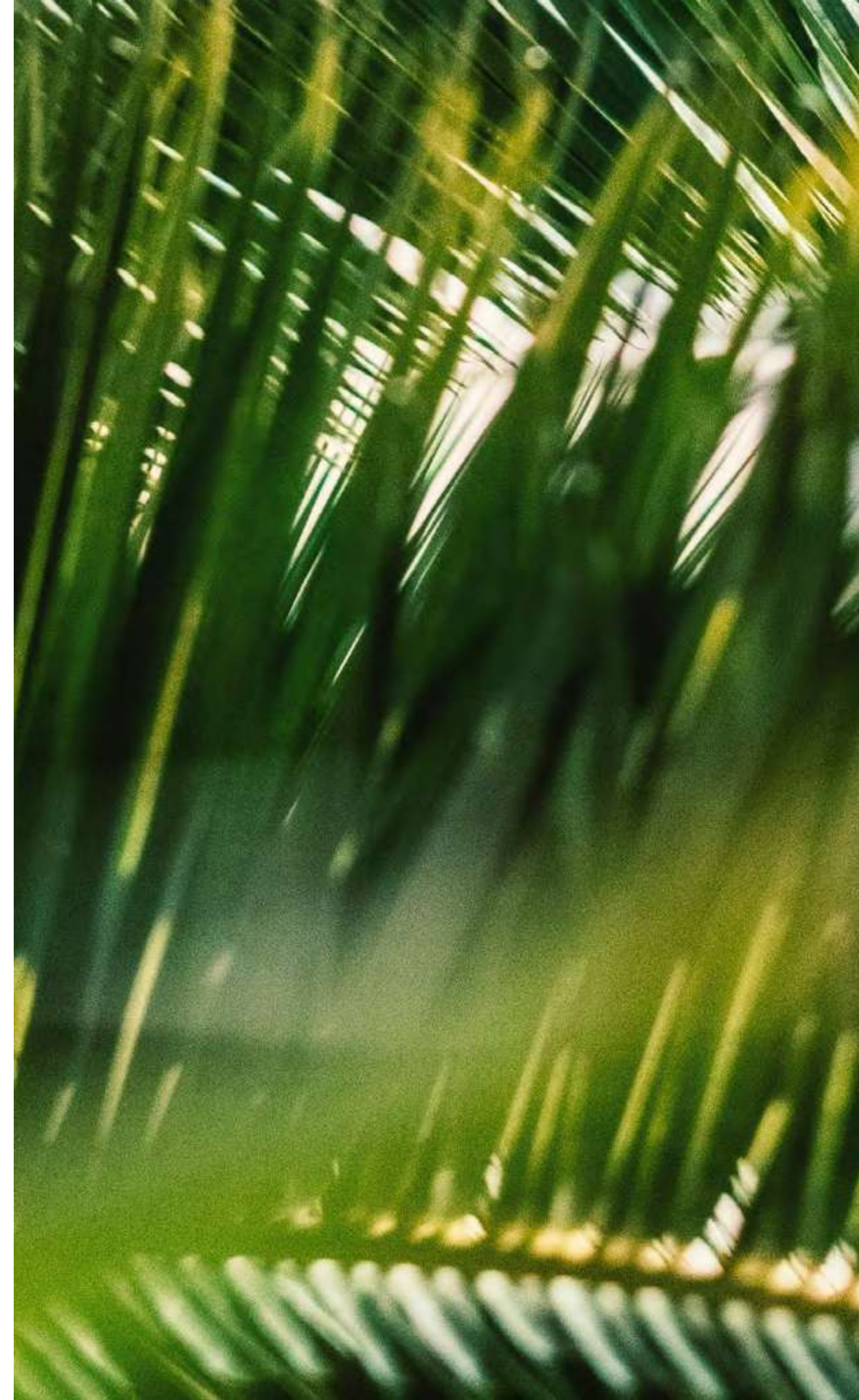

CAPTURING THE WONDERS OF NATURE

Mina Al Arab is devoted to preserving and showcasing the beauty of the Arabian Gulf and its ecosystem, home to a variety of fascinating marine life. With more than 2 million square meters of protected mangrove area, flamingo reserve, turtles and more. Providing a unique opportunity to live in a vibrant environment and experience the beauty of the surroundings on a daily basis.





MINA AL ARAB MASTERPLAN

- 01. THE BEACH FRONT
- 02. GRANDA VILLAS
- 03. LAGOON WALK
- 04. MALIBU VILLAS
- 05. FLAMINGO VILLAS
- 06. ANANTARA RESORT & SPA
- 07. ECO LODGE
- 08. MARBELLA VILLAS I
- 09. MARBELLA VILLAS II
- 10. GATEWAY II RESIDENCES
- 11. INTERCONTINENTAL HOTEL: RESORT & SPA
- 12. BAY RESIDENCES
- 13. NASIM LOFTS
- 14. BAY VIEWS
- 15. CAPE HAYAT
- 16. BERMUDA VILLAS
- 17. GATEWAY I RESIDENCES
- 18. PORTO PLAYA BY ELLINGTON PROPERTIES
- 19. THE HARBOUR

HOLIDAY LIVING - EVERYDAY

Everyday convenience meets a laidback lifestyle at Hayat Island. With a dynamic community rooted in unique experiences, Hayat Island is an embodiment of island life.



CAPE HAYAT

01. CAPE HAYAT

02. BAYVIEWS

03. BAY RESIDENCES

04. NASIM LOFTS

05. INTERCONTINENTAL HOTEL RESORT & SPA

06. MARBELLA VILLAS I

07. MARBELLA VILLAS II

08. GATEWAY II RESIDENCES

09. LIFESTYLE HOTEL & VILLAS

10. BRANDED APARTMENTS

11. BRANDED VILLAS

12. PORTO PLAYA BY ELLINGTON PROPERTIES





UNMATCHED HOSPITALITY OFFERINGS AT YOUR DOORSTEP

~



INTERCONTINENTAL®

RAS AL KHAIMAH
MINA AL ARAB RESORT & SPA

The prestigious InterContinental Mina Al Arab Resort is located on Hayat Island, with 350 guest rooms and suites, as well as dazzling facilities that include a health club, spa, two swimming pools, fitness centre, and a selection of restaurants.

With the diverse and spectacular Ras Al Khaimah fast on the rise as the UAE's desired destination for getaways, nature, and relaxation, the InterContinental Mina Al Arab Resort is a top choice for guests and residents that are used only to the best, and expect it at every turn.

ANANTARA HOTEL

Anantara Mina Al Arab Ras Al Khaimah Resort will feature the emirate's first Maldivian inspired overwater villas complex. With a 9,000 sqm private beach which overlooks the stunning eco-reserve lined with mangroves, the resort will also be home to a number of first class health and sports amenities such as the world-famous Anantara Spa, swimming pools and a tennis court.



In addition, the resort will have four restaurant offerings, including a Thai specialty restaurant and a seafood restaurant, all of which creates the perfect ambience to both relax and be entertained.



SAY HELLO
TO GOLDEN
SANDS AND
STUNNING
VISTAS

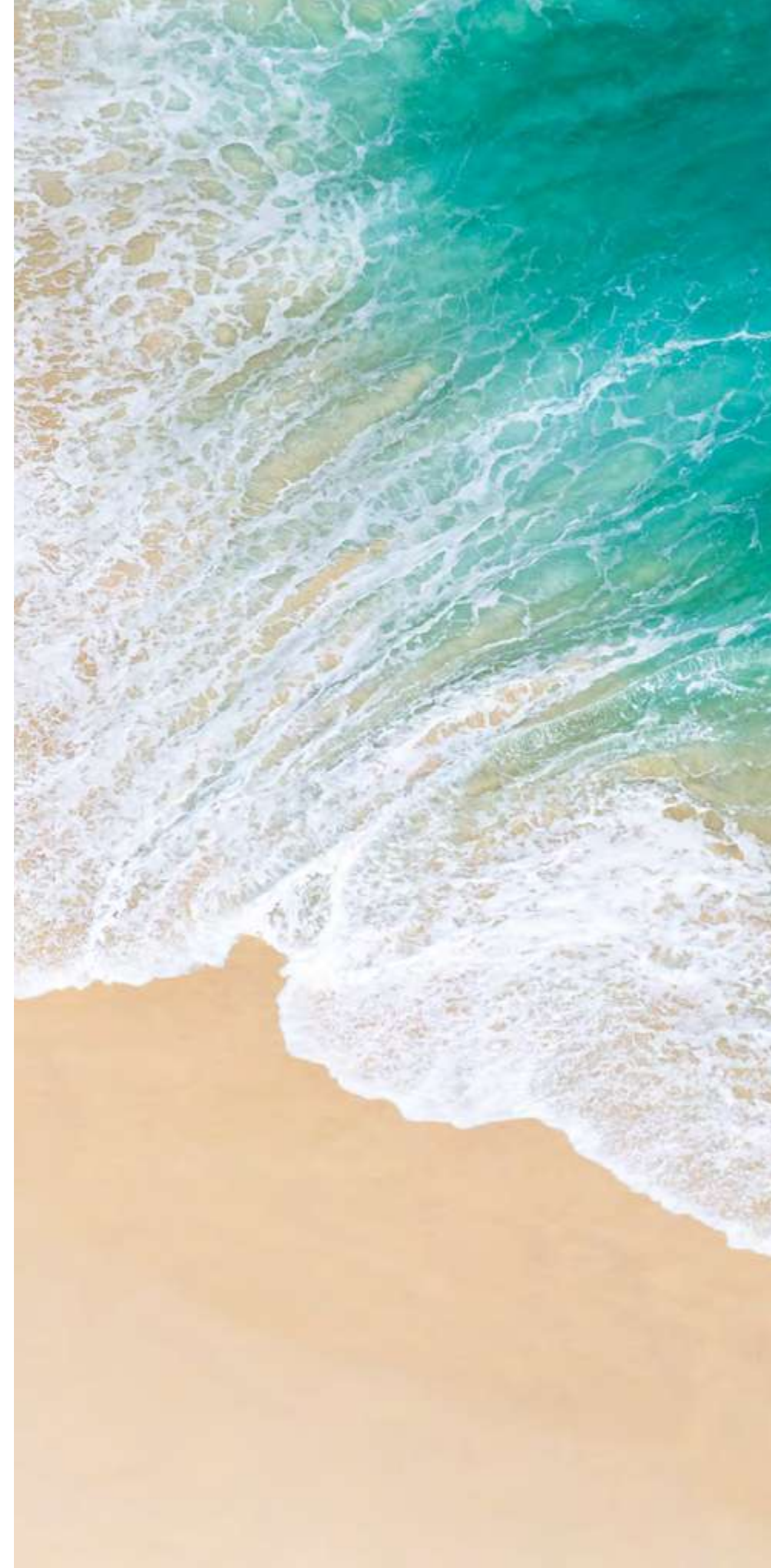

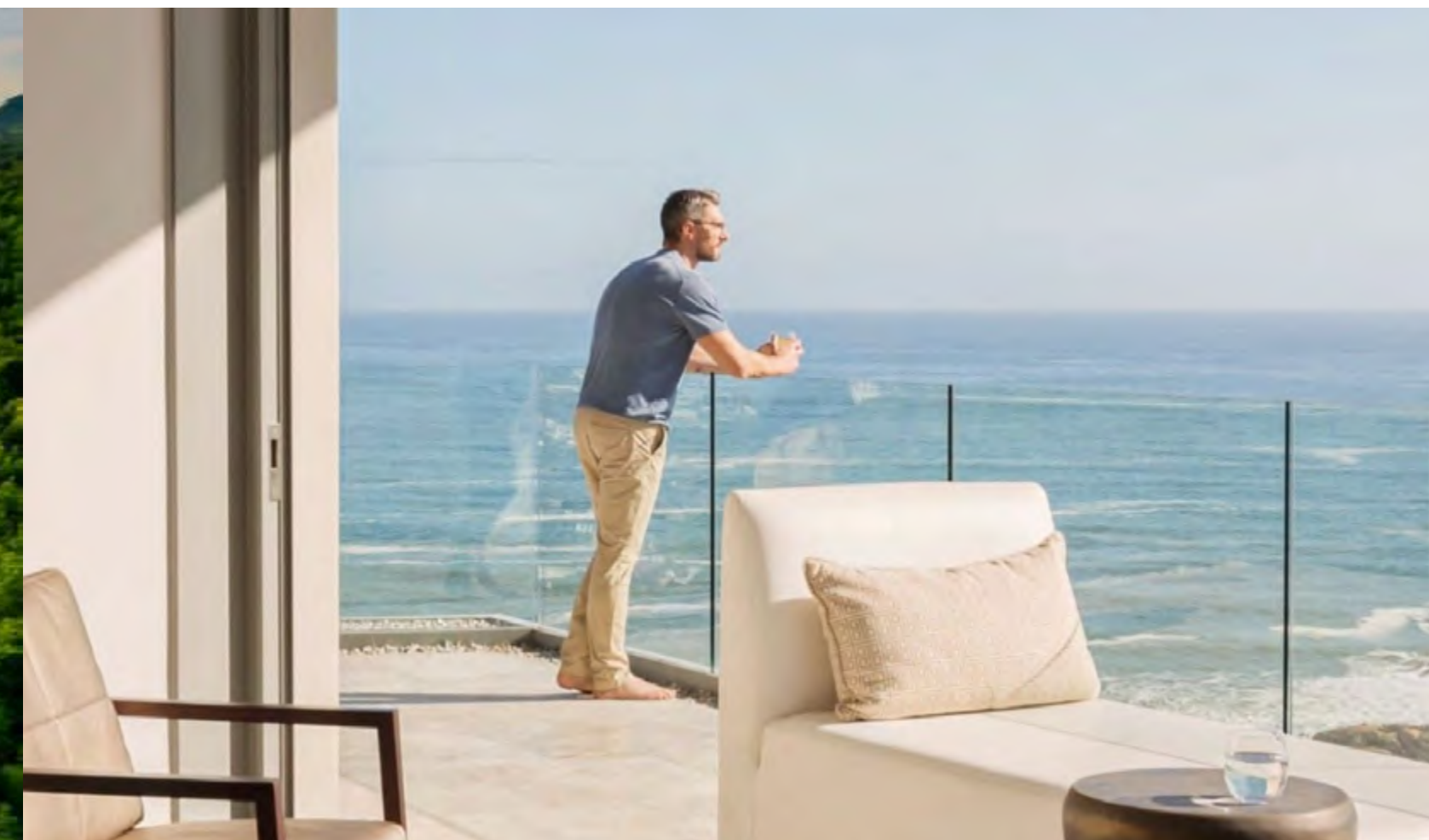
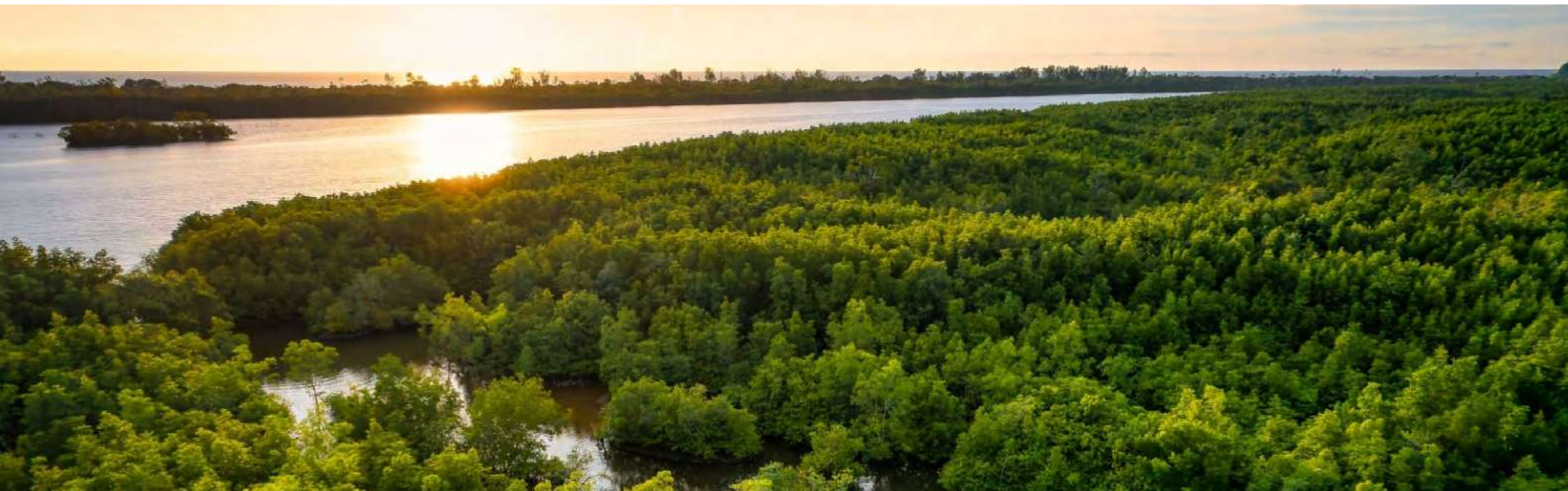

Cape Hayat signifies a luxurious enclave on Hayat Island, invoking the essence of a coastal retreat. With unmatched views of the ocean and mangroves, Cape Hayat echoes the harmony of thoughtful design and nature, creating moments of unmatched beauty for its residents.

From studios, 1 & 2BR apartments to 4 BR Penthouses, our design celebrates the essence of seaside living with panoramic vistas that redefine luxury.

BREATHING SPACE FOR ALL

Built with an open layout in mind, each residential unit at Cape Hayat allows for panoramic views of either the ocean, the canal or the mangroves. Never miss a sunset at Cape Hayat from the unique vantage point of your home.







SUSTAINABLE & STYLISH

~
At Cape Hayat sustainability is a way of life.

We have carefully integrated eco-conscious features into every aspect of our design, ensuring a harmonious coexistence with the environment. From using locally sourced materials, to energy efficient lighting and water management features, from 12 EV charging stations to ensuring ample natural light with full height windows; our design principles reflect our commitment to sustainability while delivering an immersive, vibrant lifestyle.





A VIBRANT COMMUNITY AWAITS

At the heart of Cape Hayat is our vibrant community – a place where residents and guests come together to create memories and celebrate life. Whether you're looking for relaxation, adventure, or simply the pleasure of good company, you'll find it here.

Come, experience the best of luxury hospitality, fine dining and retail offerings at your doorstep. Where every day is a holiday, and every moment is a cherished memory.

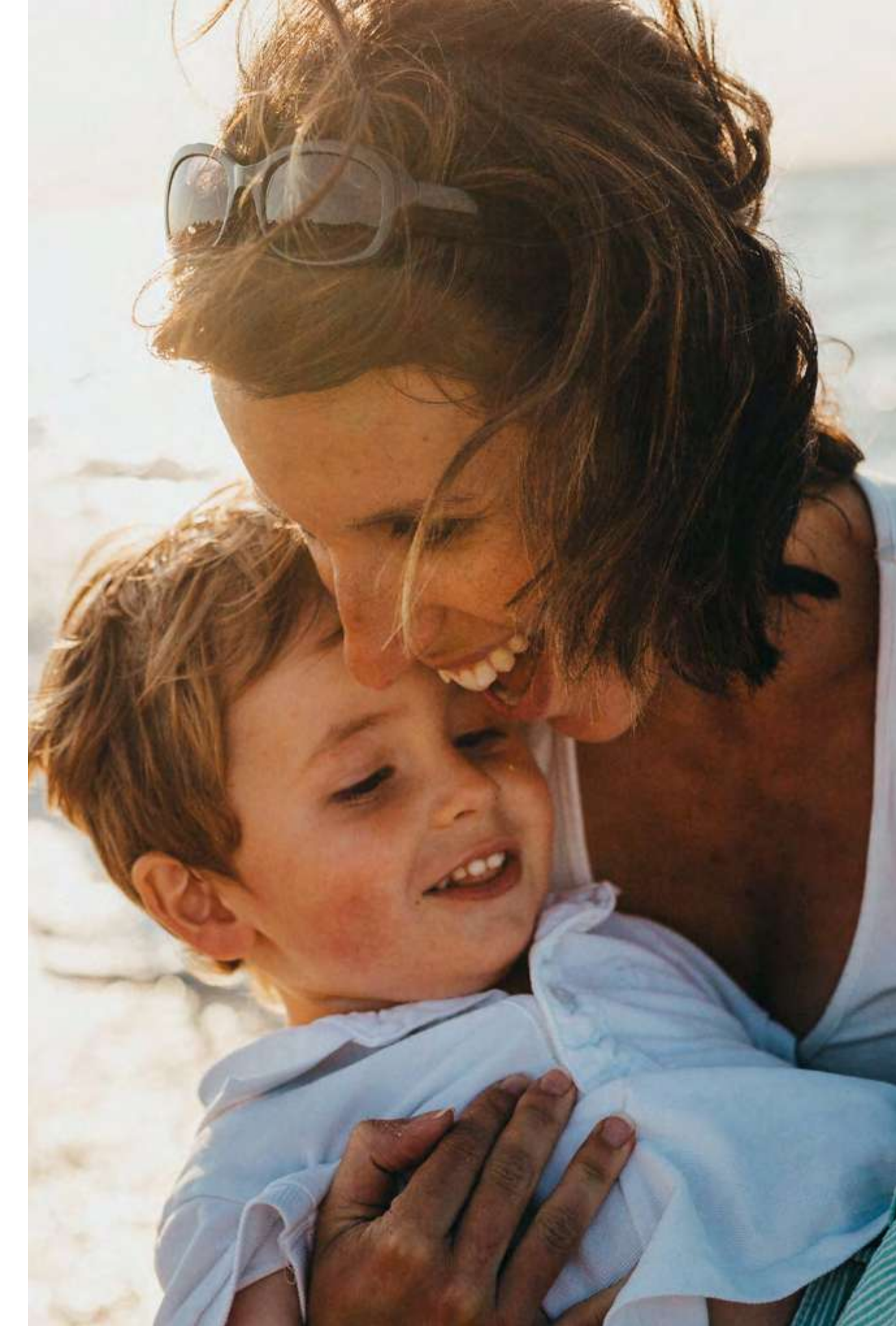



Discover the true meaning of luxury at Cape Hayat; where the blue sky is an extension of the open sea; where exceptional entertainment venues are a delightful stroll away; and time is measured by the sound of waves rolling into the shore.

 Studio, 1, 2 & 4-Bedrooms

 Beach Access

 Swimming Pool

 Views of the Sea

 Fully Equipped Gym

 Retail Front at Ground Level





1BR DINING
& KITCHEN AREA



1BR LIVING ROOM



2BR BED ROOM



2BR KITCHEN



4BR PENTHOUSE
DINING AREA



PENTHOUSE LOBBY
& PRIVATE POOL



PENTHOUSE
FORMAL LOUNGE



PENTHOUSE
BATHROOM

IMPECCABLE FROM EVERY ANGLE

~



Come home to living spaces that exude sophistication, comfort with large windows welcoming in natural light and providing wonderful views of the sea. A neutral material palette adding a warm ambiance.

TYPICAL TOWER

Studio Type 1 (Central)

| TYPE 1 | SQ.F | SQ.M |
|----------------|--------|-------|
| Apartment Area | 387.39 | 35.99 |
| Balcony Area | 78.58 | 7.30 |
| Total Area | 465.97 | 43.29 |

| FLOOR | UNIT NO. |
|----------------------------|----------------|
| Tower 2 & Tower 3: L01 | 02, 03, 06, 07 |
| Tower 2 & Tower 3: L02-L03 | 05, 06, 09, 10 |
| Tower 2 & Tower 3: L04-L19 | 04, 05, 08, 09 |
| Tower 1 & Tower 4: L01-L03 | 05, 06, 09, 10 |
| Tower 1 & Tower 4: L04-L08 | 04, 05, 08, 09 |

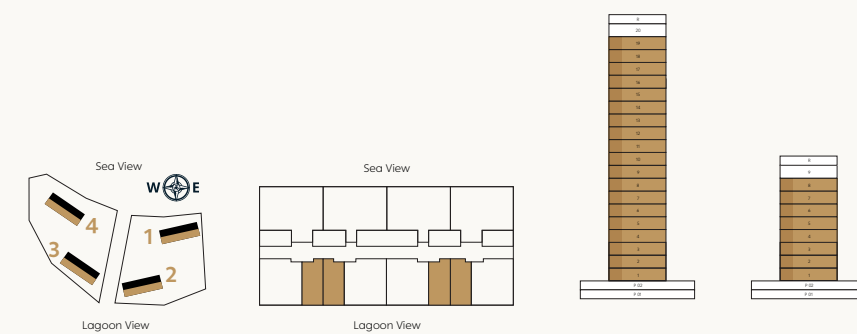

Floor plan numbers, square footage, and floor plans are approximate. Final dimensions, square footage and floor plans may vary or may be mirrored. Balcony area varies depending on location of unit on the floor.



TYPICAL TOWER

1 Bedroom Type 1 (Corner)

| TYPE 1 | SQ.F | SQ.M |
|----------------|--------|-------|
| Apartment Area | 820.53 | 76.23 |
| Balcony Area | 159.41 | 14.81 |
| Total Area | 979.94 | 91.04 |

| FLOOR | UNIT NO. |
|----------------------------|----------|
| Tower 2 & Tower 3: L01 | 01, 08 |
| Tower 2 & Tower 3: L02-L03 | 04, 11 |
| Tower 2 & Tower 3: L04-L19 | 03, 10 |
| Tower 1 & Tower 4: L01-L03 | 04, 11 |
| Tower 1 & Tower 4: L04-L08 | 03, 10 |

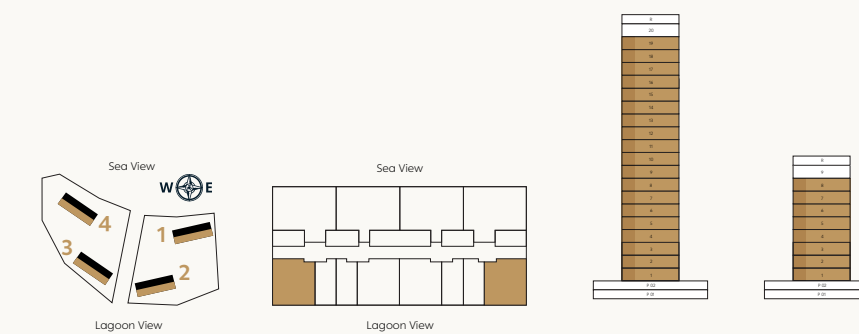

Floor plan numbers, square footage, and floor plans are approximate. Final dimensions, square footage and floor plans may vary or may be mirrored. Balcony area varies depending on location of unit on the floor.



TYPICAL TOWER

1 Bedroom Type 2 (Central)

| TYPE 1 | SQ.F | SQ.M |
|----------------|--------|-------|
| Apartment Area | 806.86 | 74.96 |
| Balcony Area | 157.05 | 14.59 |
| Total Area | 963.91 | 89.55 |

| FLOOR | UNIT NO. |
|----------------------------|----------|
| Tower 2 & Tower 3: L01 | 04, 05 |
| Tower 2 & Tower 3: L02-L03 | 07, 08 |
| Tower 2 & Tower 3: L04-L19 | 06, 07 |
| Tower 1 & Tower 4: L01-L03 | 07, 08 |
| Tower 1 & Tower 4: L04-L08 | 06, 07 |

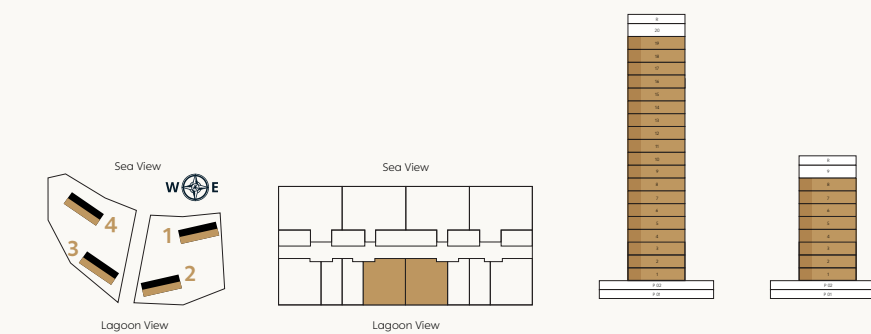

Floor plan numbers, square footage, and floor plans are approximate. Final dimensions, square footage and floor plans may vary or may be mirrored. Balcony area varies depending on location of unit on the floor.



TYPICAL TOWER

1 Bedroom Type 3 (Corner)

| TYPE 1 | SQ.F | SQ.M |
|----------------|---------|--------|
| Apartment Area | 883.61 | 82.09 |
| Balcony Area | 291.92 | 27.12 |
| Total Area | 1175.53 | 109.21 |

| FLOOR | UNIT NO. |
|----------------------------|----------|
| Tower 2 & Tower 3: L02-L03 | 03, 012 |
| Tower 1 & Tower 4: L01-L03 | 03, 012 |

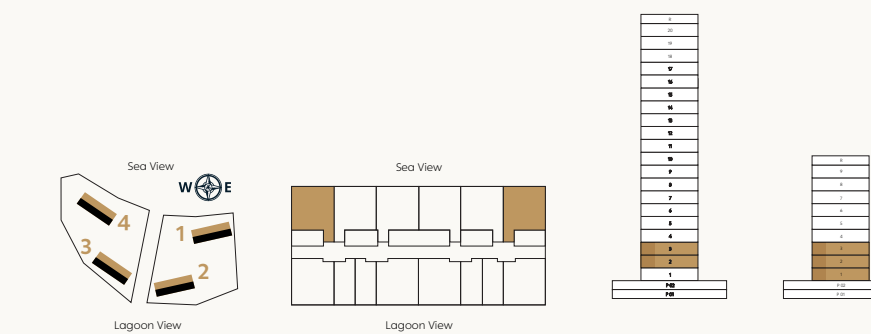

Floor plan numbers, square footage, and floor plans are approximate. Final dimensions, square footage and floor plans may vary or may be mirrored. Balcony area varies depending on location of unit on the floor.



TYPICAL TOWER

1 Bedroom Type 4 (Middle)

| TYPE 1 | SQ.F | SQ.M |
|----------------|---------|-------|
| Apartment Area | 798.79 | 74.21 |
| Balcony Area | 204.51 | 19.00 |
| Total Area | 1003.30 | 93.21 |

| FLOOR | UNIT NO. |
|----------------------------|----------|
| Tower 2 & Tower 3: L02-L03 | 02, 013 |
| Tower 1 & Tower 4: L01-L03 | 02, 013 |

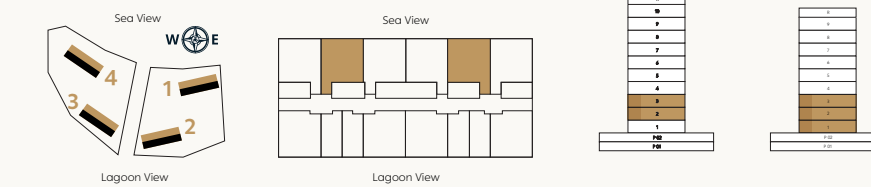

Floor plan numbers, square footage, and floor plans are approximate. Final dimensions, square footage and floor plans may vary or may be mirrored. Balcony area varies depending on location of unit on the floor.

TYPICAL TOWER

1 Bedroom Type 5 (Central)

| TYPE 1 | SQ.F | SQ.M |
|----------------|--------|-------|
| Apartment Area | 769.30 | 71.47 |
| Balcony Area | 205.70 | 19.11 |
| Total Area | 975.00 | 90.58 |

| FLOOR | UNIT NO. |
|----------------------------|----------|
| Tower 2 & Tower 3: L02-L03 | 01, 014 |
| Tower 1 & Tower 4: L01-L03 | 01, 014 |

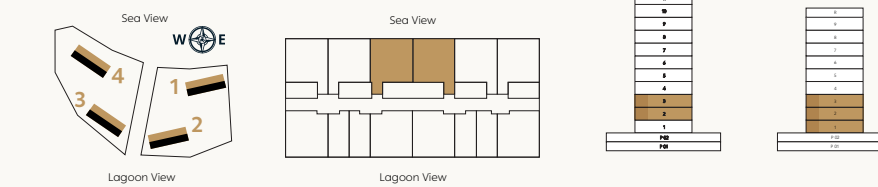

Floor plan numbers, square footage, and floor plans are approximate. Final dimensions, square footage and floor plans may vary or may be mirrored. Balcony area varies depending on location of unit on the floor.

TYPICAL TOWER

2 Bedroom Type 1 (Corner)

| TYPE 1 | SQ.F | SQ.M |
|----------------|---------|--------|
| Apartment Area | 1324.61 | 123.06 |
| Balcony Area | 390.51 | 36.28 |
| Total Area | 1715.12 | 159.34 |

| FLOOR | UNIT NO. |
|----------------------------|----------|
| Tower 2 & Tower 3: L04-L19 | 02, 011 |
| Tower 1 & Tower 4: L04-L08 | 02, 011 |

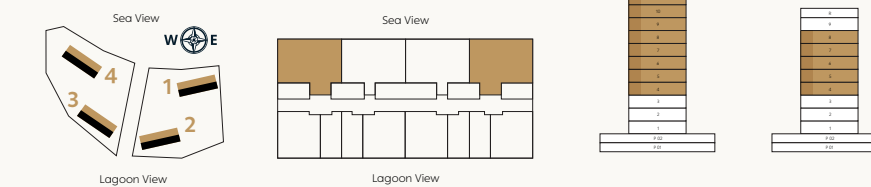

Floor plan numbers, square footage, and floor plans are approximate. Final dimensions, square footage and floor plans may vary or may be mirrored. Balcony area varies depending on location of unit on the floor.

TYPICAL TOWER

2 Bedroom Type 2 (Middle)

| TYPE 1 | SQ.F | SQ.M |
|----------------|---------|--------|
| Apartment Area | 1140.54 | 105.96 |
| Balcony Area | 306.77 | 28.50 |
| Total Area | 1447.31 | 134.46 |

| FLOOR | UNIT NO. |
|----------------------------|----------|
| Tower 2 & Tower 3: L04-L19 | 01, 012 |
| Tower 1 & Tower 4: L04-L08 | 01, 012 |

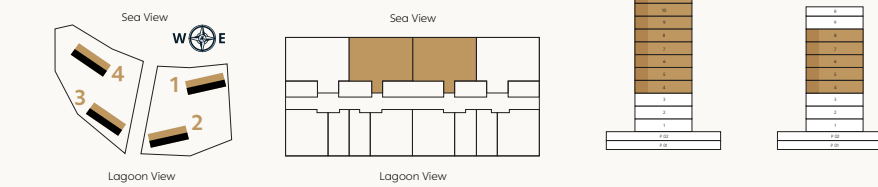

Floor plan numbers, square footage, and floor plans are approximate. Final dimensions, square footage and floor plans may vary or may be mirrored. Balcony area varies depending on location of unit on the floor.

TYPICAL TOWER

Penthouse Type 1 (North East Podium)

| TYPE 1 | SQ.F | SQ.M |
|----------------|---------|--------|
| Apartment Area | 5097.57 | 473.58 |
| Balcony Area | 1768.08 | 164.26 |
| Total Area | 6865.65 | 637.84 |

| FLOOR | UNIT NO. |
|--------------|----------|
| Tower 1: L09 | PH1 |
| Tower 2: L20 | PH1 |

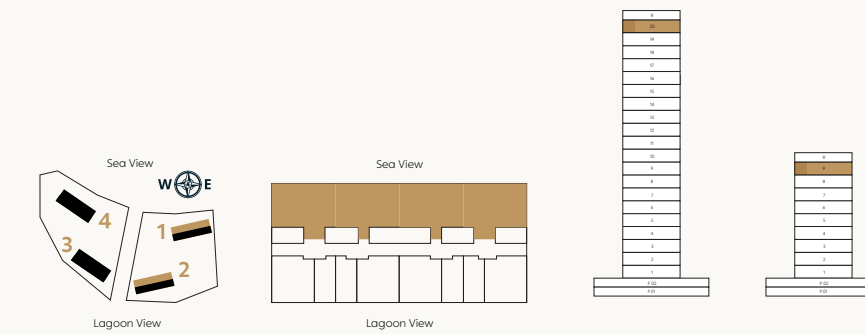

Floor plan numbers, square footage, and floor plans are approximate. Final dimensions, square footage and floor plans may vary or may be mirrored. Balcony area varies depending on location of unit on the floor.

TYPICAL TOWER

Penthouse Type 1 (North West Podium)

| TYPE 1 | SQ.F | SQ.M |
|----------------|---------|--------|
| Apartment Area | 5101.23 | 473.92 |
| Balcony Area | 1787.99 | 166.11 |
| Total Area | 6889.22 | 640.03 |

| FLOOR | UNIT NO. |
|--------------|----------|
| Tower 3: L20 | PH1 |
| Tower 4: L09 | PH1 |

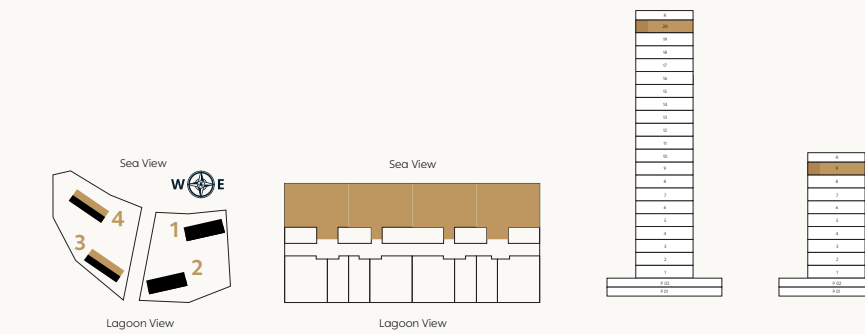

Floor plan numbers, square footage, and floor plans are approximate. Final dimensions, square footage and floor plans may vary or may be mirrored. Balcony area varies depending on location of unit on the floor.

TYPICAL TOWER

Penthouse Type 2 (South East Podium)

| TYPE 1 | SQ.F | SQ.M |
|----------------|---------|--------|
| Apartment Area | 5108.23 | 474.57 |
| Balcony Area | 1711.46 | 159.00 |
| Total Area | 6819.69 | 633.57 |

| FLOOR | UNIT NO. |
|--------------|----------|
| Tower 1: L09 | PH2 |
| Tower 2: L20 | PH2 |

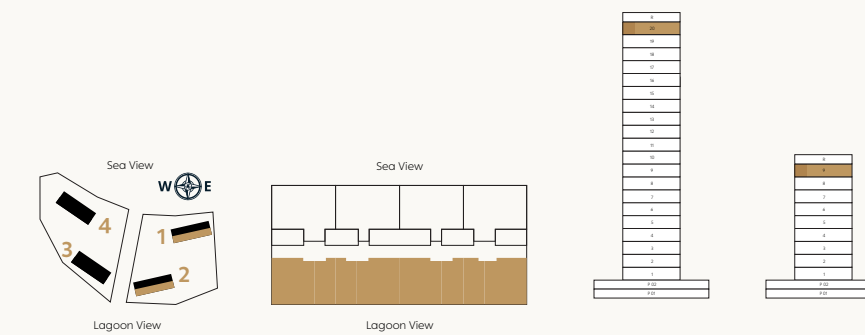

Floor plan numbers, square footage, and floor plans are approximate. Final dimensions, square footage and floor plans may vary or may be mirrored. Balcony area varies depending on location of unit on the floor.

TYPICAL TOWER

Penthouse Type 2 (South West Podium)

| TYPE 1 | SQ.F | SQ.M |
|----------------|---------|--------|
| Apartment Area | 4976.05 | 462.29 |
| Balcony Area | 1441.61 | 133.93 |
| Total Area | 6417.66 | 596.22 |

| FLOOR | UNIT NO. |
|--------------|----------|
| Tower 3: L20 | PH2 |
| Tower 4: L09 | PH2 |

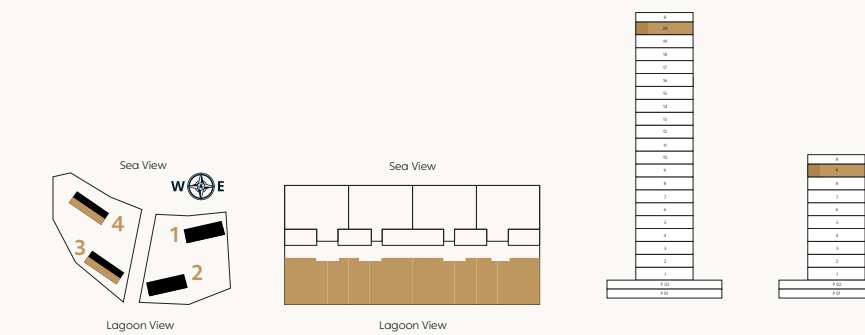

Floor plan numbers, square footage, and floor plans are approximate. Final dimensions, square footage and floor plans may vary or may be mirrored. Balcony area varies depending on location of unit on the floor.

CAPE HAYAT

TOWER 1

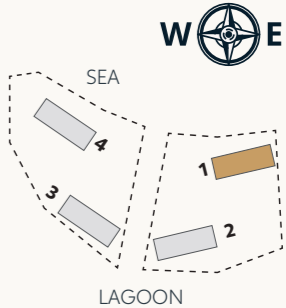

LEVEL 01

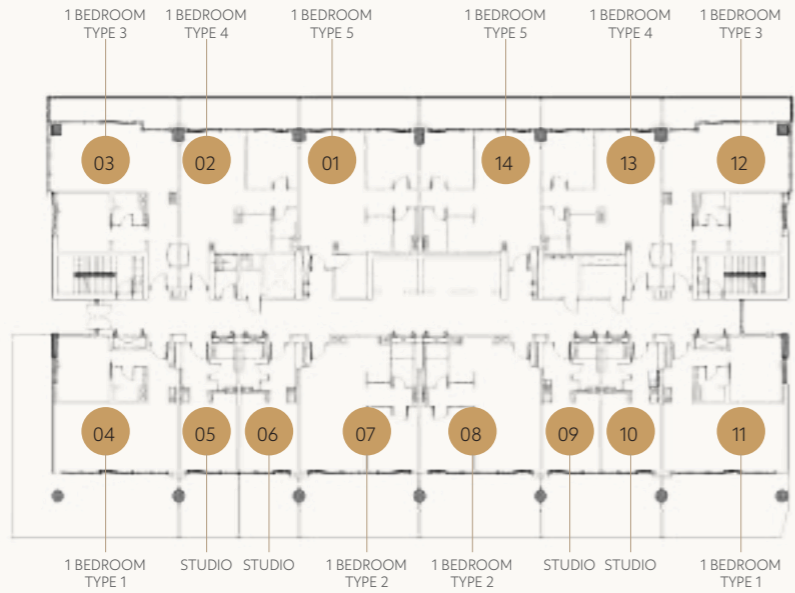

LEVELS 02-03

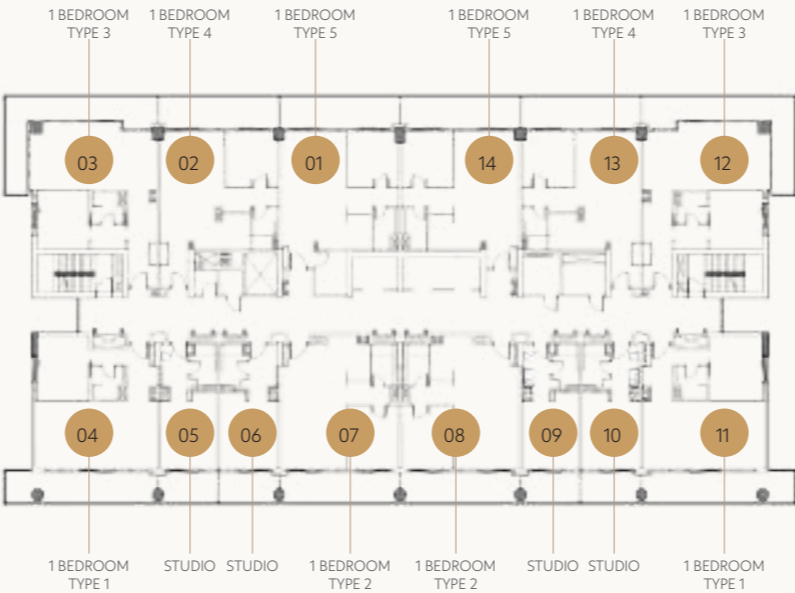

LEVELS 04-08

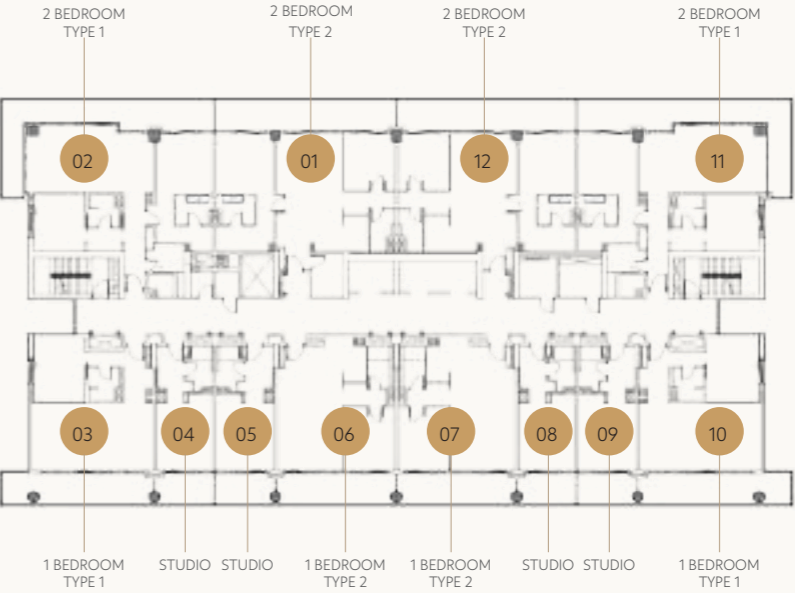

CAPE HAYAT

TOWER 2

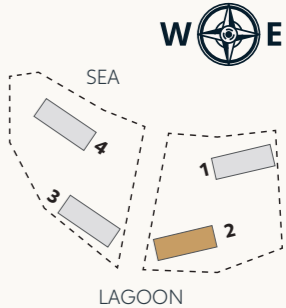

LEVEL 01

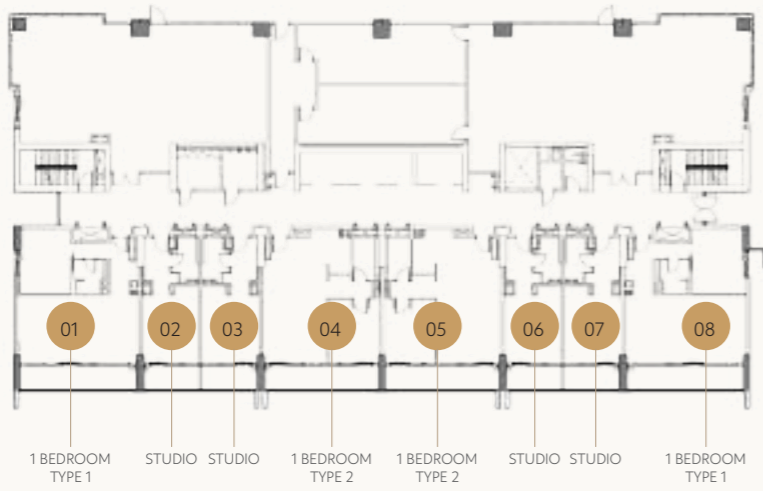

LEVELS 02-03

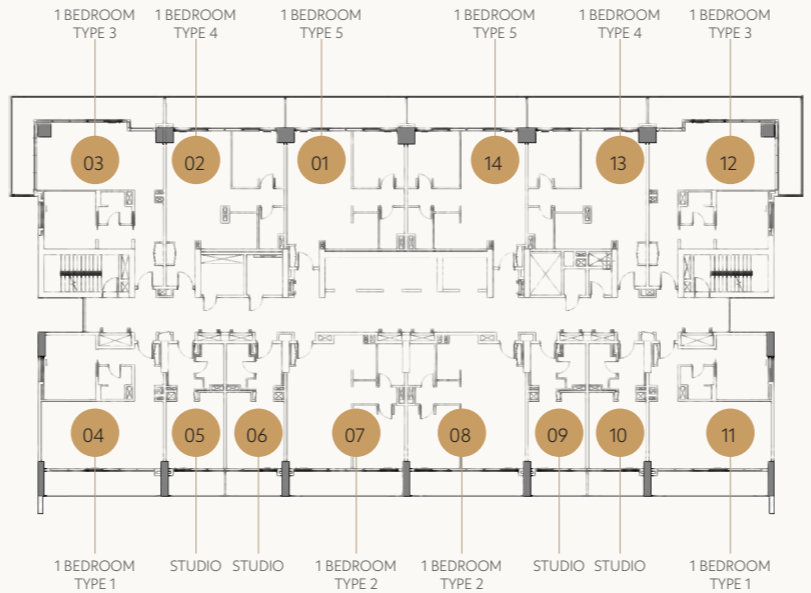

LEVELS 04-19

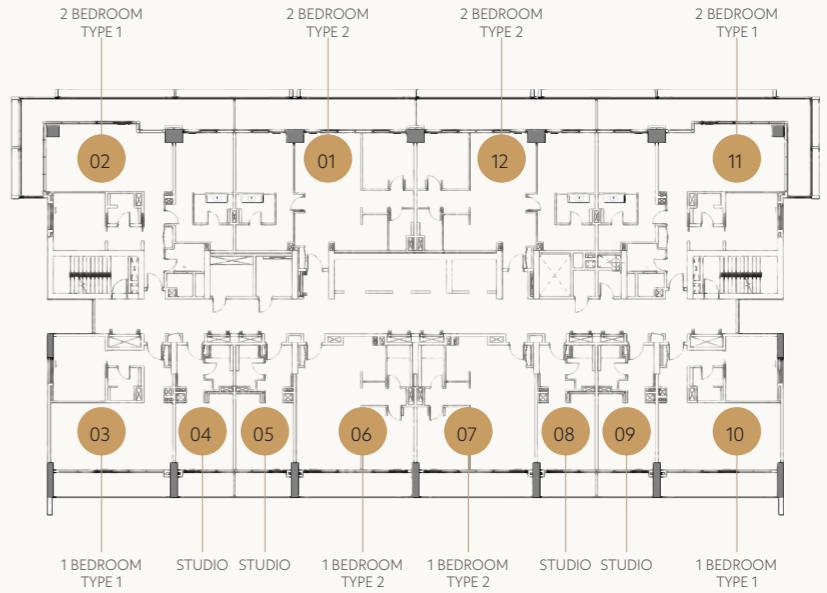

CAPE HAYAT

TOWER 3

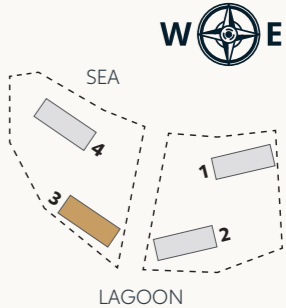

LEVEL 01

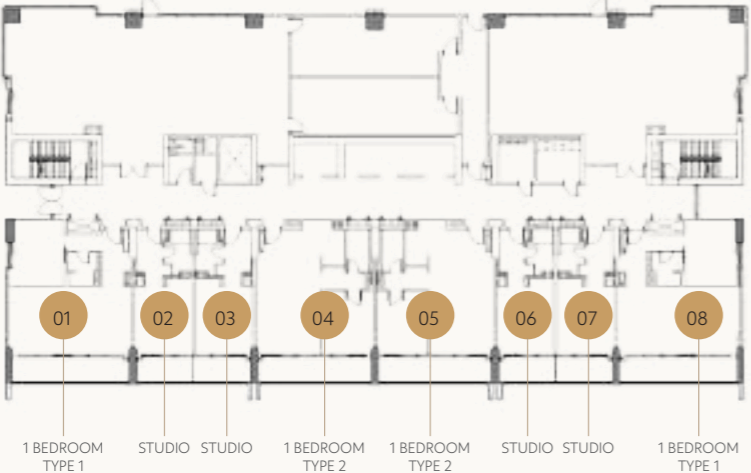

LEVELS 02-03

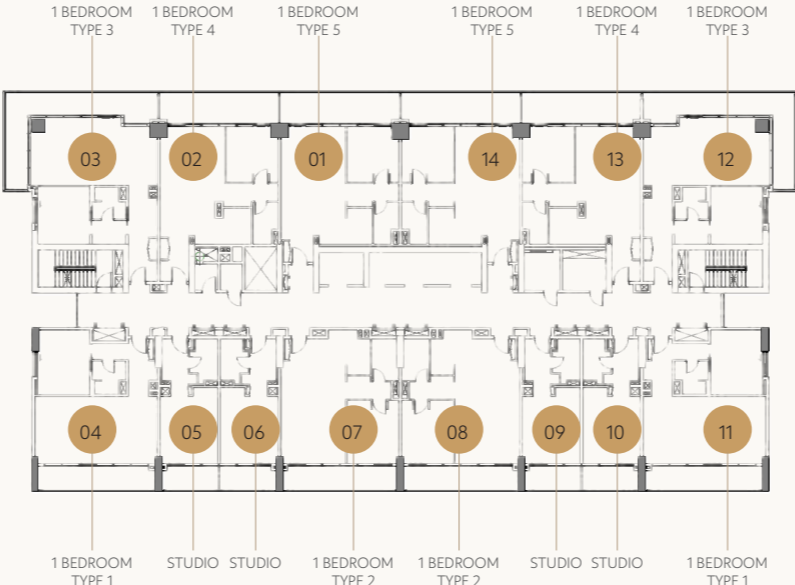

LEVELS 04-19

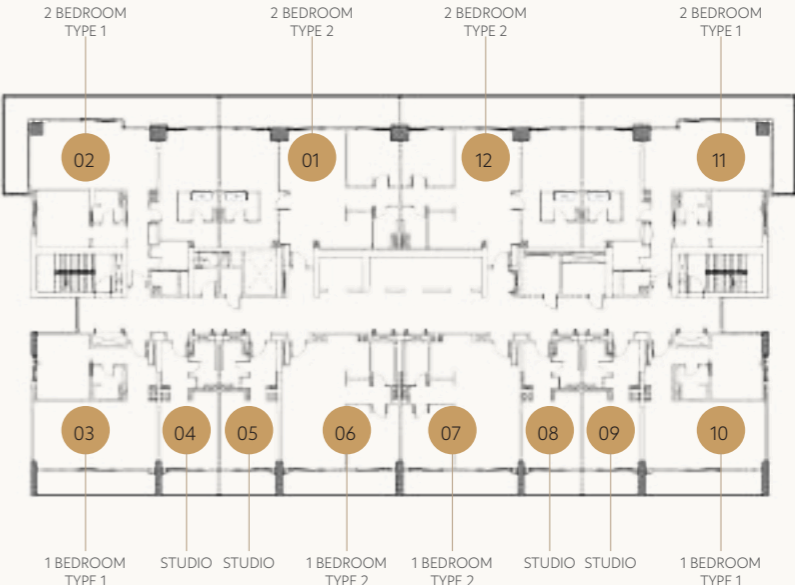

CAPE HAYAT

TOWER 4

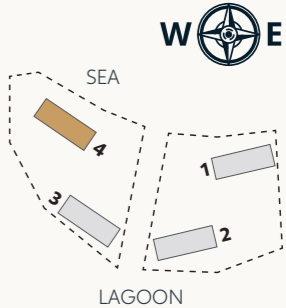

LEVEL 01

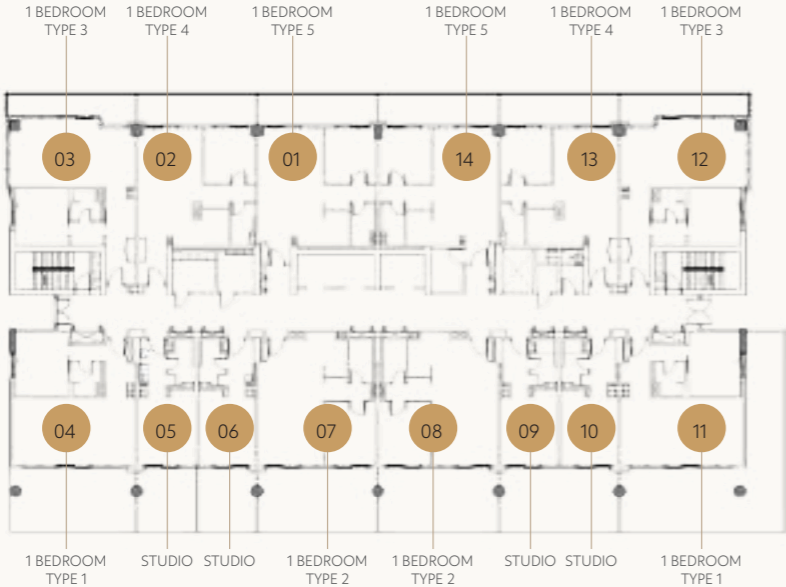

LEVELS 02-03

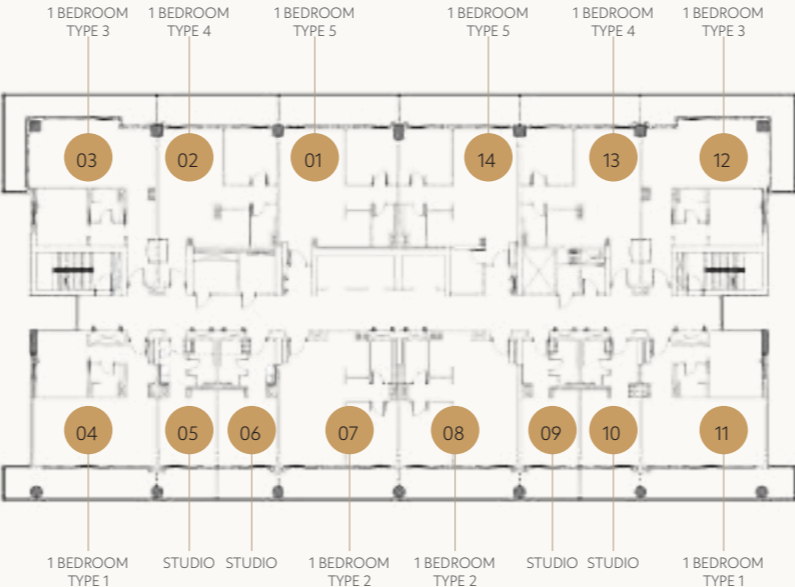

LEVELS 04-08

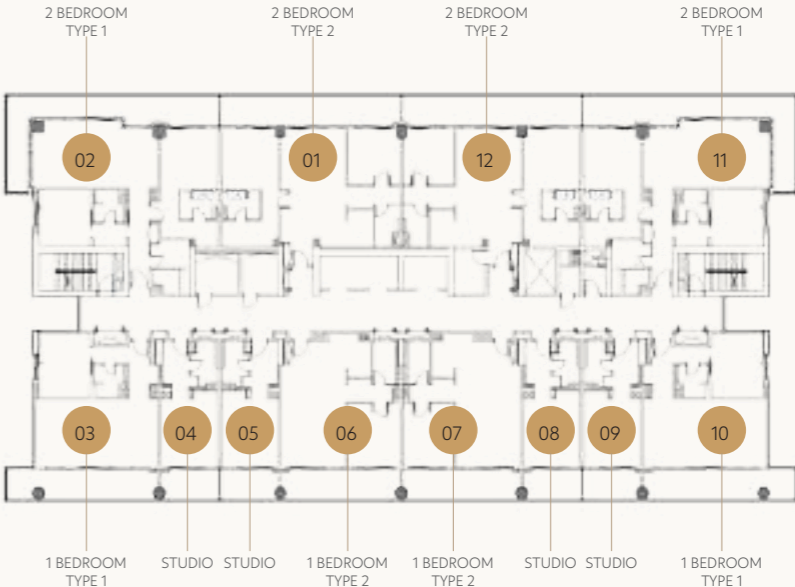

CAPE HAYAT

A CURATED COLLECTION BY RAK PROPERTIES



FOR MORE INFORMATION PLEASE CALL 800 40 20

RAKPROPERTIES.AE

رأس الخيمة العقارية
RAK PROPERTIES