

DUBAI HILLS

ESTATE

EXECUTIVE RESIDENCES II

FLOOR PLANS

PARK RIDGE BY

EMAAR

DUBAI HILLS ESTATE

EXECUTIVE RESIDENCES II

PARK RIDGE TOWER B

1 BEDROOM APARTMENT 1A&B - TOWER B

LEVEL	UNIT NO	UNIT AREA		BALCONY AREA		TOTAL AREA	
		SQM	SQFT.	SQM.	SQFT.	SQM.	SQFT.
GROUND	G07	56.54	608.59	25.01	269.21	81.55	877.80
	G08	56.88	612.25	26.15	281.48	83.03	893.73
	G09	56.10	603.86	24.94	268.45	81.04	872.31
	G10	56.41	607.19	24.15	259.95	80.56	867.14
	G11	56.41	607.19	24.94	268.45	81.35	875.64
	G12	56.41	607.19	25.22	271.47	81.63	878.66
	G13	56.41	607.19	24.75	266.41	81.16	873.60
	G14	56.41	607.19	24.61	264.90	81.02	872.09
	G18	56.43	607.41	24.54	264.15	80.97	871.56

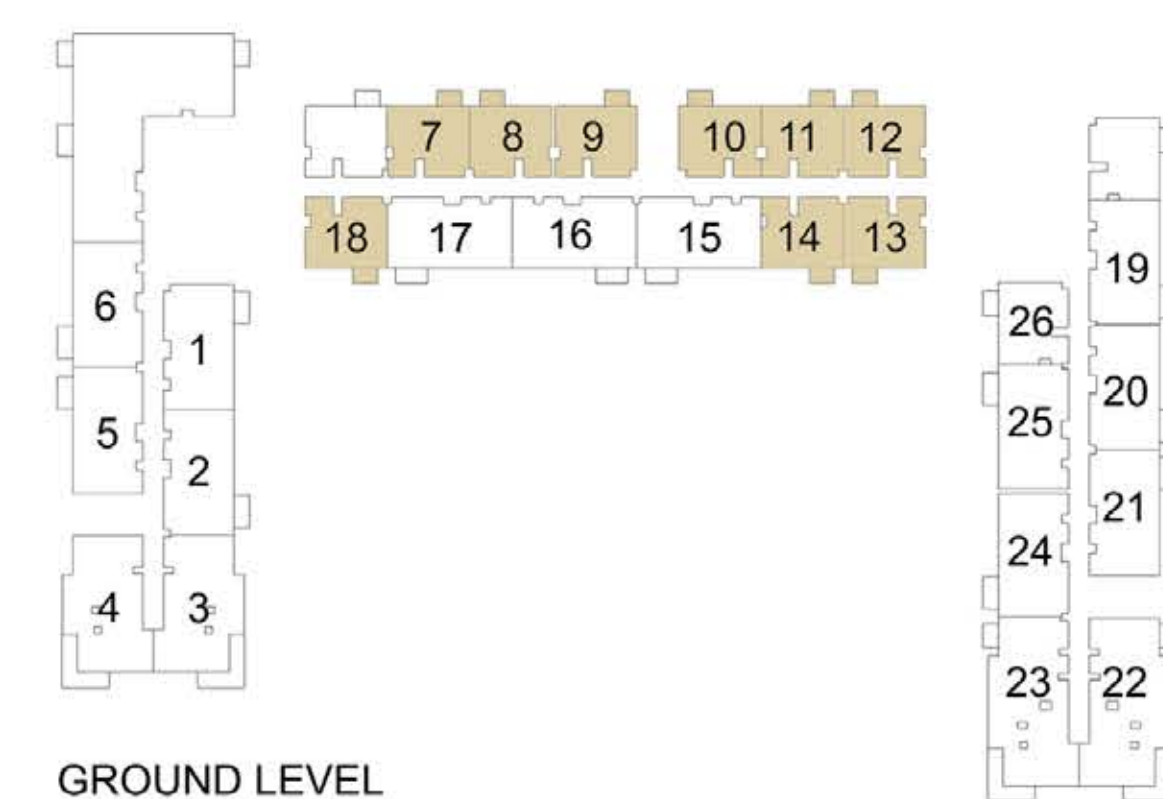
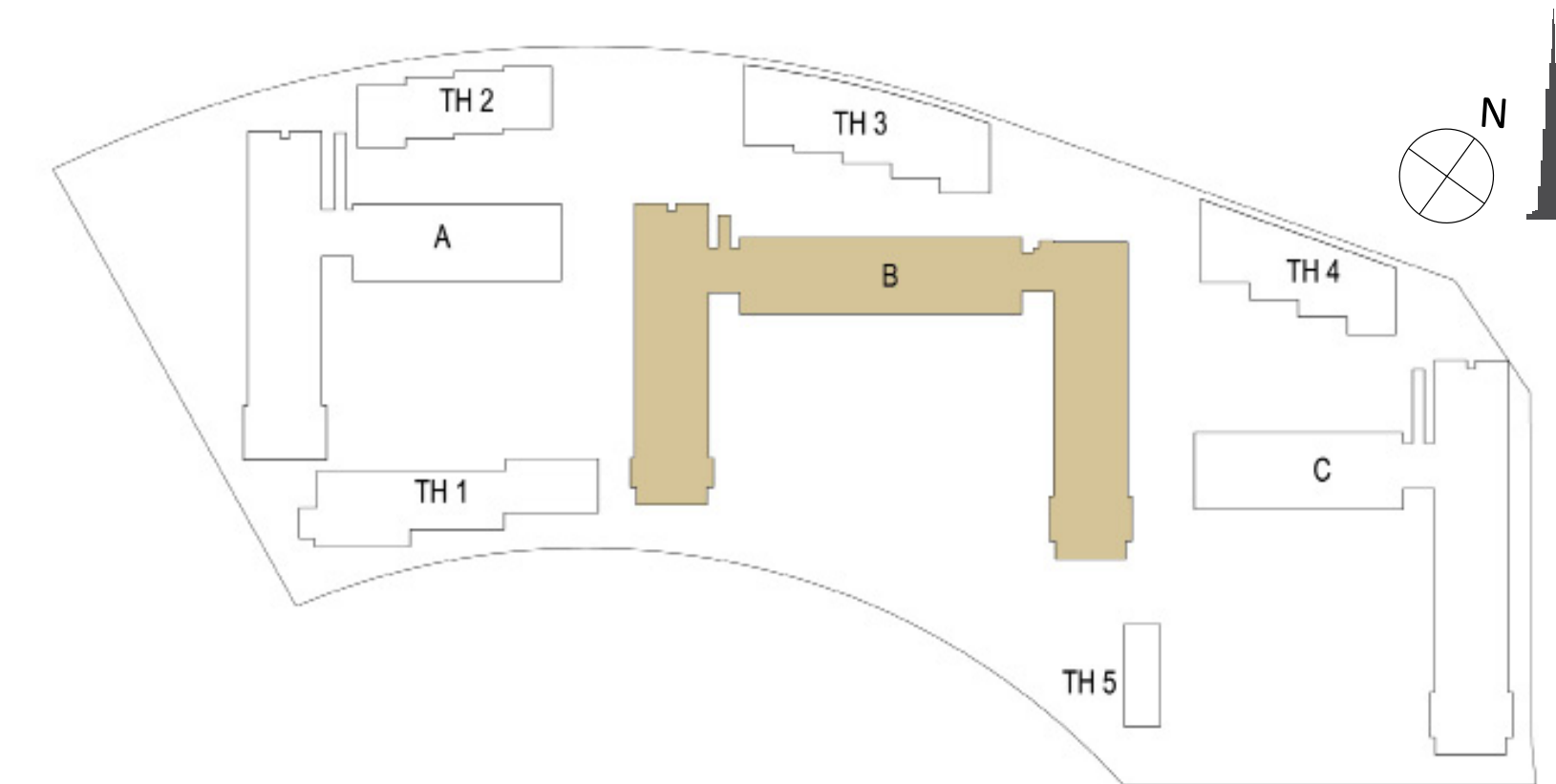

GROUND LEVEL

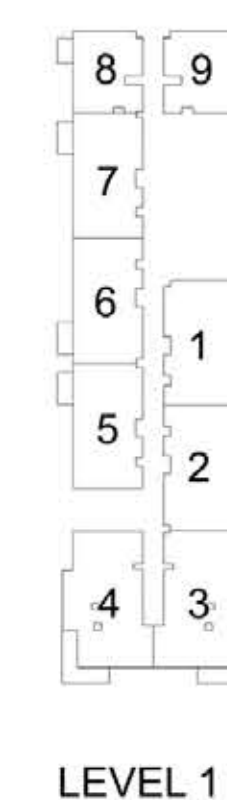

LEVEL 1

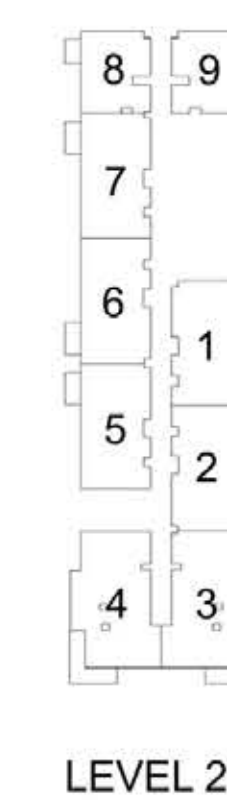

LEVEL 2-7

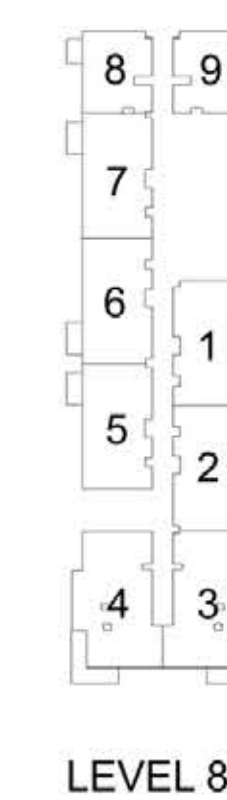
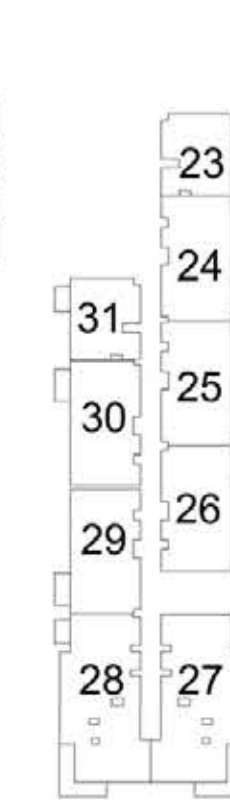

LEVEL 8



LEVEL 9



LEVEL 10

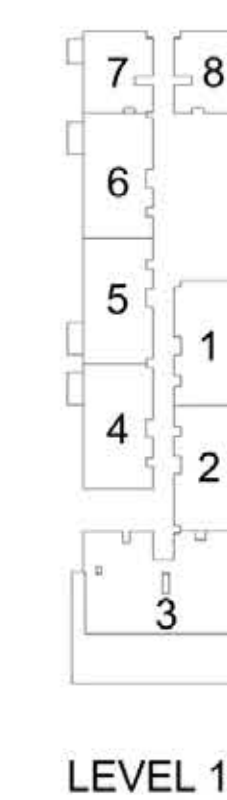

LEVEL 10

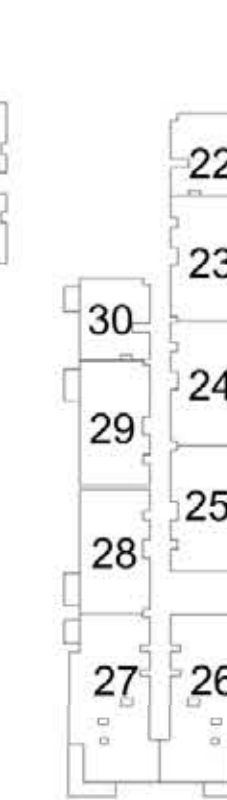

LEVEL 11

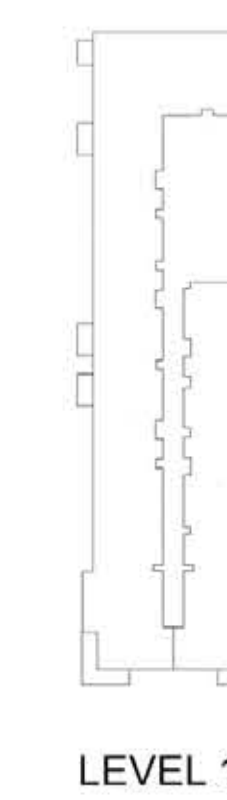

LEVEL 11



LEVEL 12

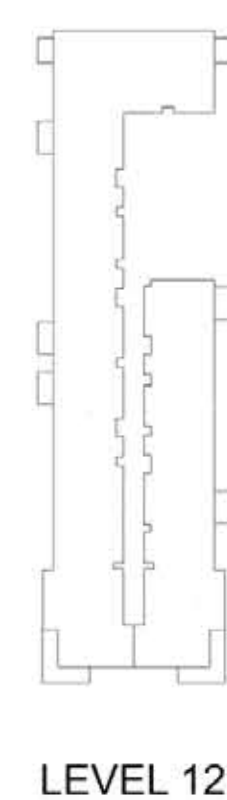

LEVEL 12

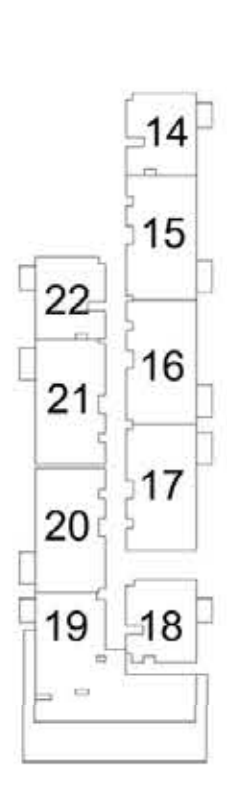

LEVEL 12

FLOOR PLAN 1. All dimensions are in imperial and metric, and measured from finish to finish excluding construction tolerances. 2. All materials, dimensions, and drawings are approximate only. 3. Information is subject to change without notice, at developer's absolute discretion. 4. Actual area may vary from the stated area. 5. Drawings not to scale. 6. All images used are for illustrative purposes only and do not represent the actual size, features, specifications, fittings, and furnishings. 7. The developer reserves the right to make revisions / alterations, at it's absolute discretion, without any liability whatsoever.

DUBAI HILLS
ESTATE

EXECUTIVE RESIDENCES II

PARK RIDGE TOWER B

1 BEDROOM APARTMENT
1C - TOWER B

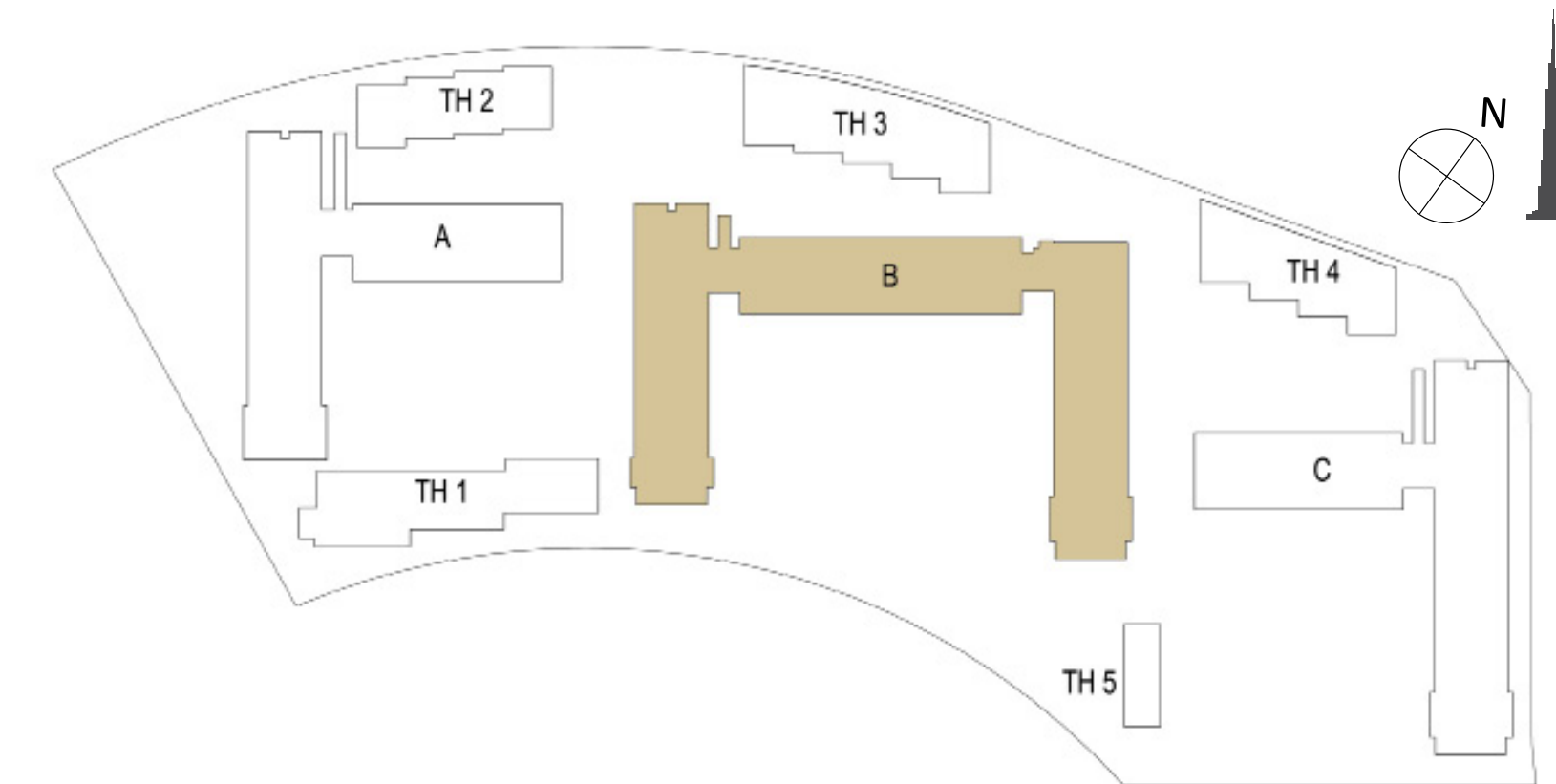

LEVEL	UNIT NO	UNIT AREA		BALCONY AREA		TOTAL AREA		
		SQM	SQFT.	SQM.	SQFT.	SQM.	SQFT.	
TOWER B								
GROUND	G26	56.31	606.12	25.40	273.40	81.71	879.52	
	108	56.06	603.42	3.99	42.95	60.05	646.37	
	109	56.63	609.56	3.99	42.95	60.62	652.51	
	110	56.16	604.50	3.99	42.95	60.15	647.45	
	111	56.55	608.70	3.99	42.95	60.54	651.65	
	112	56.88	612.25	3.99	42.95	60.87	655.20	
	LEVEL 01	115	56.41	607.19	3.99	42.95	60.40	650.14
		116	56.41	607.19	3.99	42.95	60.40	650.14
		117	56.41	607.19	3.99	42.95	60.40	650.14
		118	56.41	607.19	3.99	42.95	60.40	650.14
		122	56.43	607.41	3.99	42.95	60.42	650.36
		123	56.31	606.12	3.99	42.95	60.30	649.07
		131	56.31	606.12	3.99	42.95	60.30	649.07
208		56.06	603.42	3.99	42.95	60.05	646.37	
209		56.63	609.56	3.99	42.95	60.62	652.51	
210		56.16	604.50	3.99	42.95	60.15	647.45	
211		56.55	608.70	3.99	42.95	60.54	651.65	
212		56.88	612.25	3.99	42.95	60.87	655.20	
LEVEL 02-07		215	56.41	607.19	3.99	42.95	60.40	650.14
	216	56.41	607.19	3.99	42.95	60.40	650.14	
	217	56.41	607.19	3.99	42.95	60.40	650.14	
	218	56.41	607.19	3.99	42.95	60.40	650.14	
	222	56.43	607.41	3.99	42.95	60.42	650.36	
	223	56.31	606.12	3.99	42.95	60.30	649.07	
	231	56.31	606.12	3.99	42.95	60.30	649.07	
	808	56.06	603.42	3.99	42.95	60.05	646.37	
	810	56.16	604.50	3.99	42.95	60.15	647.45	
	811	56.55	608.70	3.99	42.95	60.54	651.65	
	812	56.88	612.25	3.99	42.95	60.87	655.20	
	815	56.41	607.19	3.99	42.95	60.40	650.14	
	LEVEL 08	816	56.41	607.19	3.99	42.95	60.40	650.14
817		56.41	607.19	3.99	42.95	60.40	650.14	
818		56.41	607.19	3.99	42.95	60.40	650.14	
822		56.43	607.41	3.99	42.95	60.42	650.36	
823		56.31	606.12	3.99	42.95	60.30	649.07	
831		56.31	606.12	3.99	42.95	60.30	649.07	

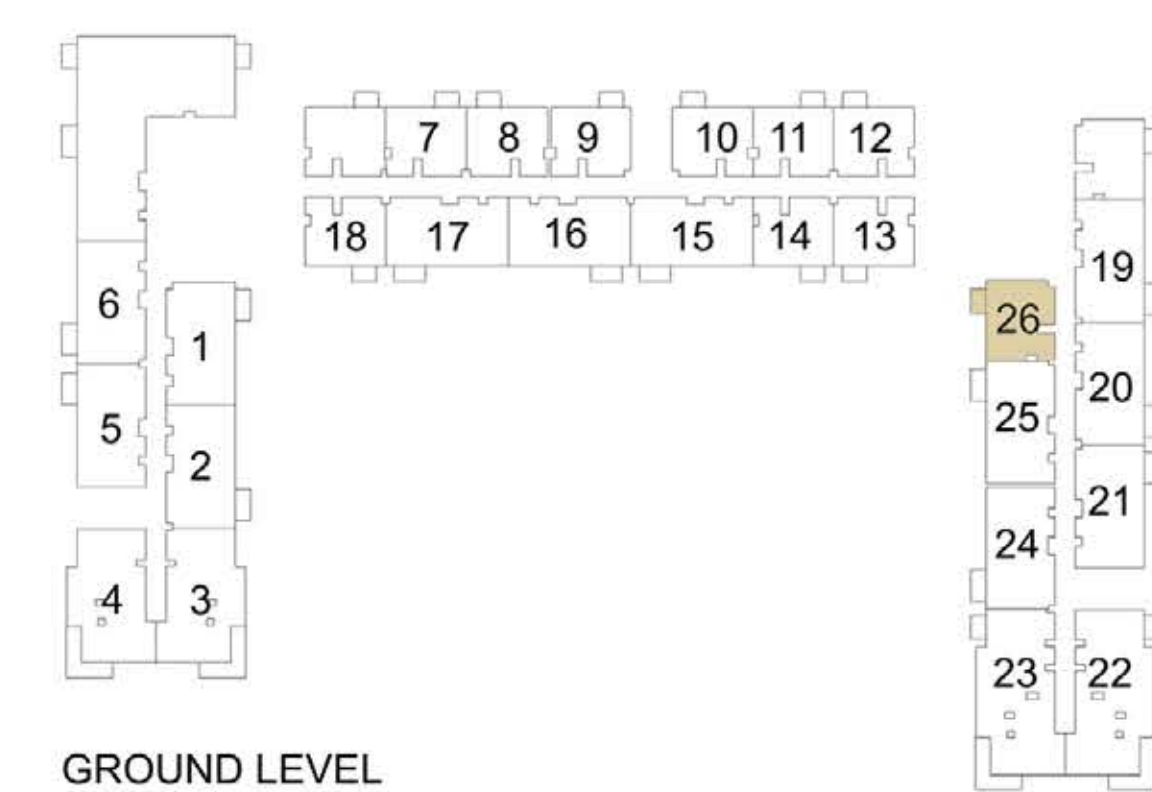

GROUND LEVEL

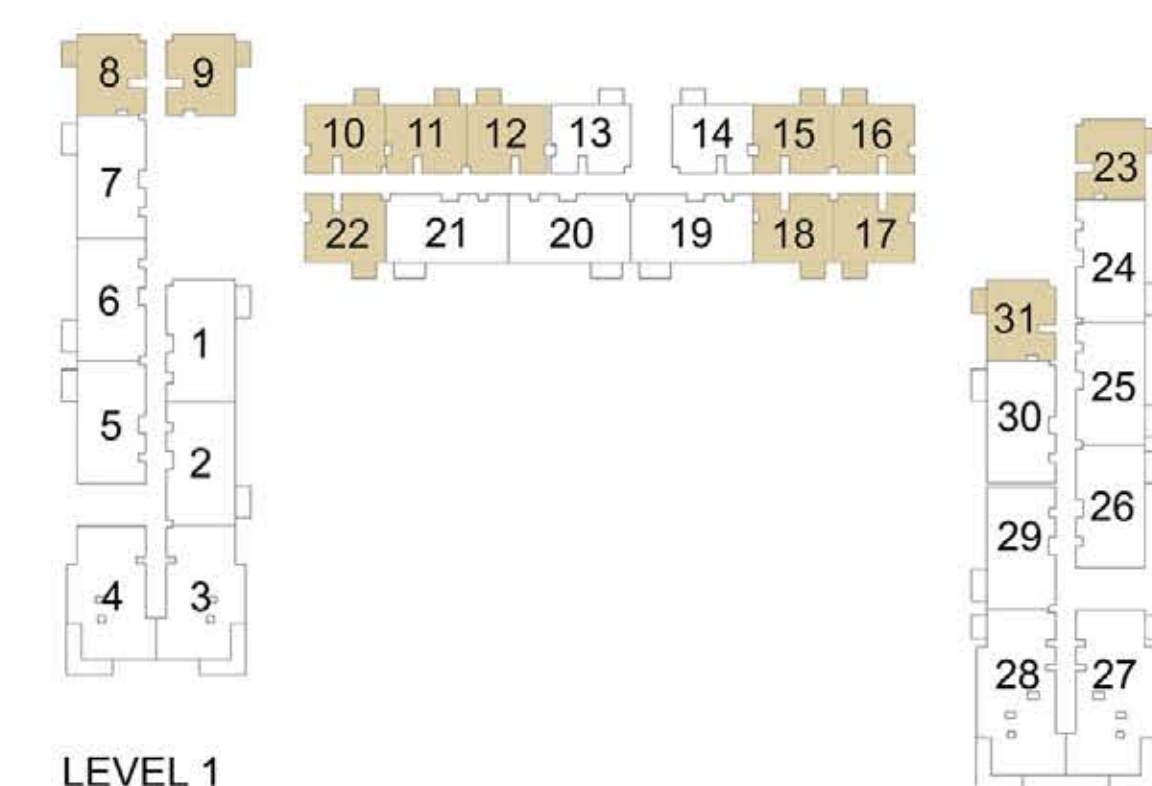

LEVEL 1

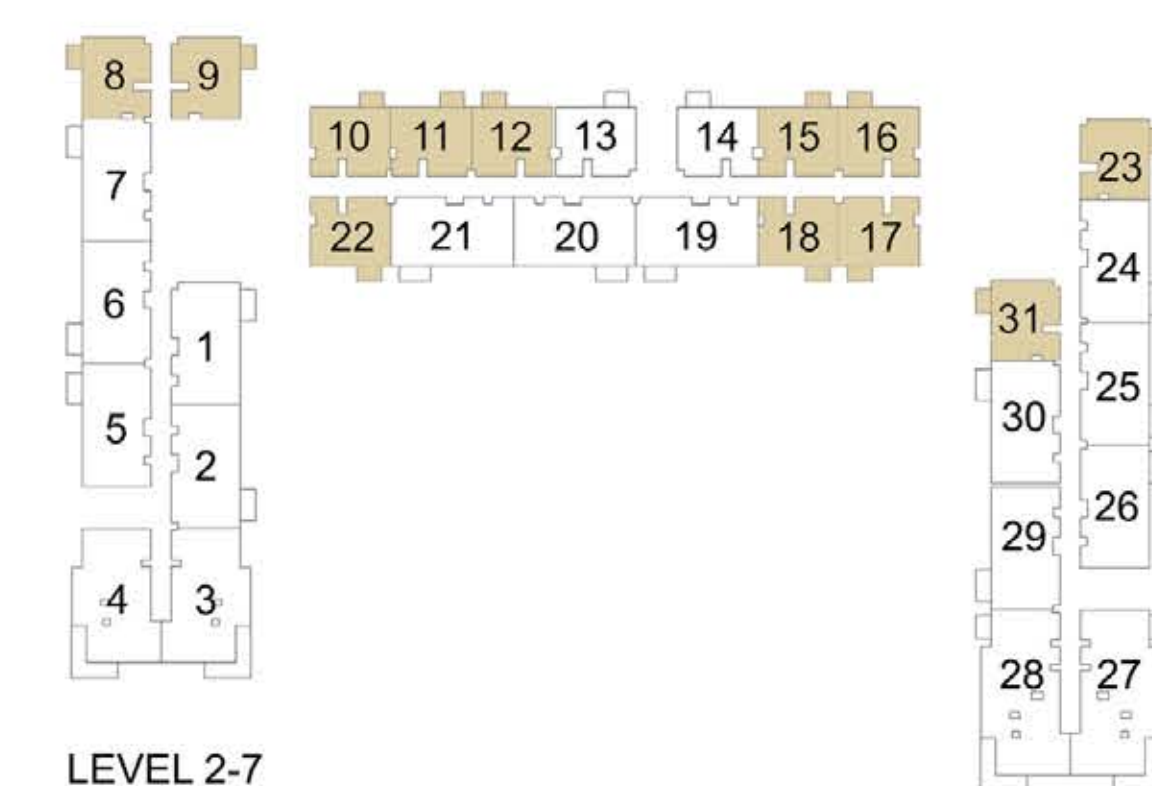

LEVEL 2-7

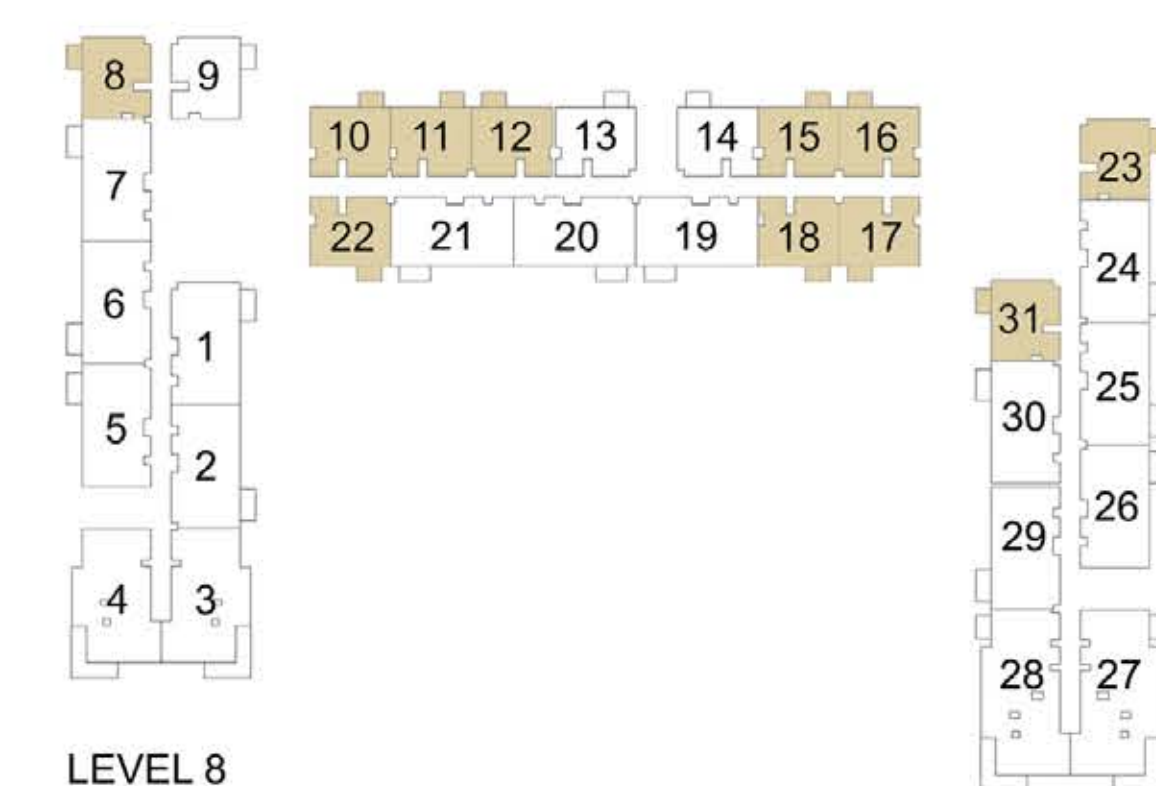

LEVEL 8

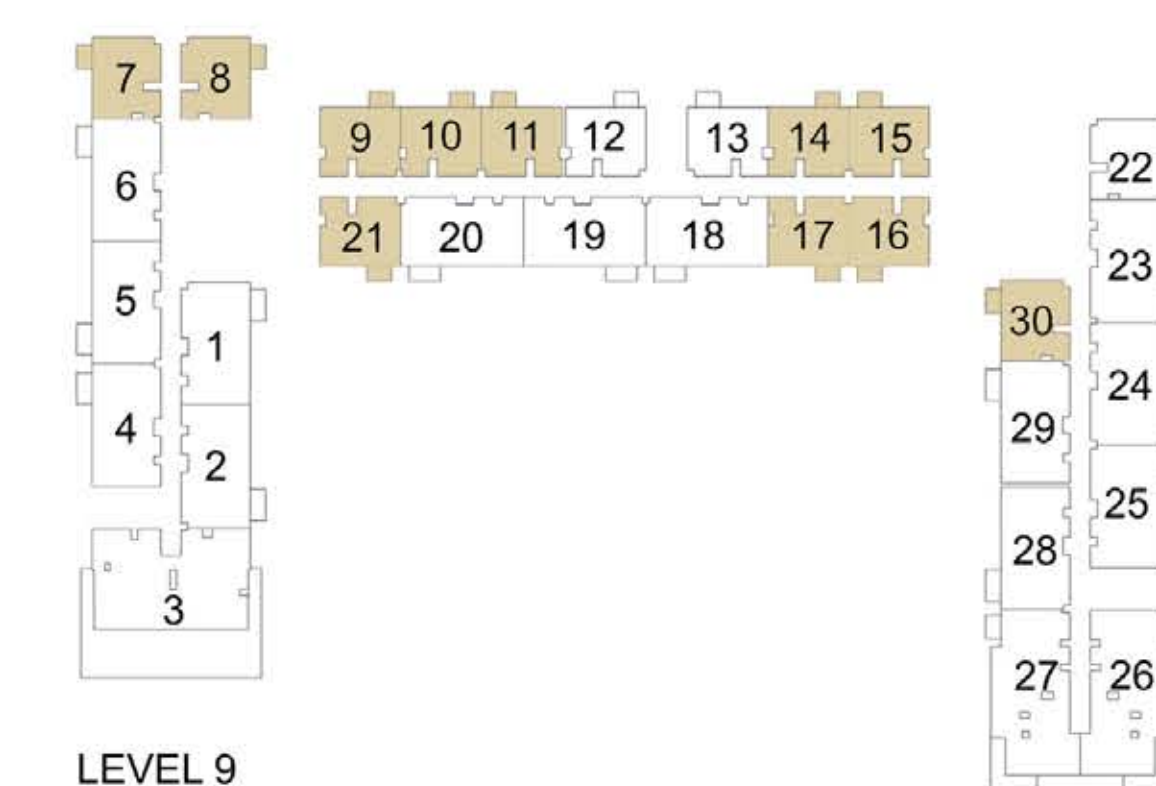

LEVEL 9

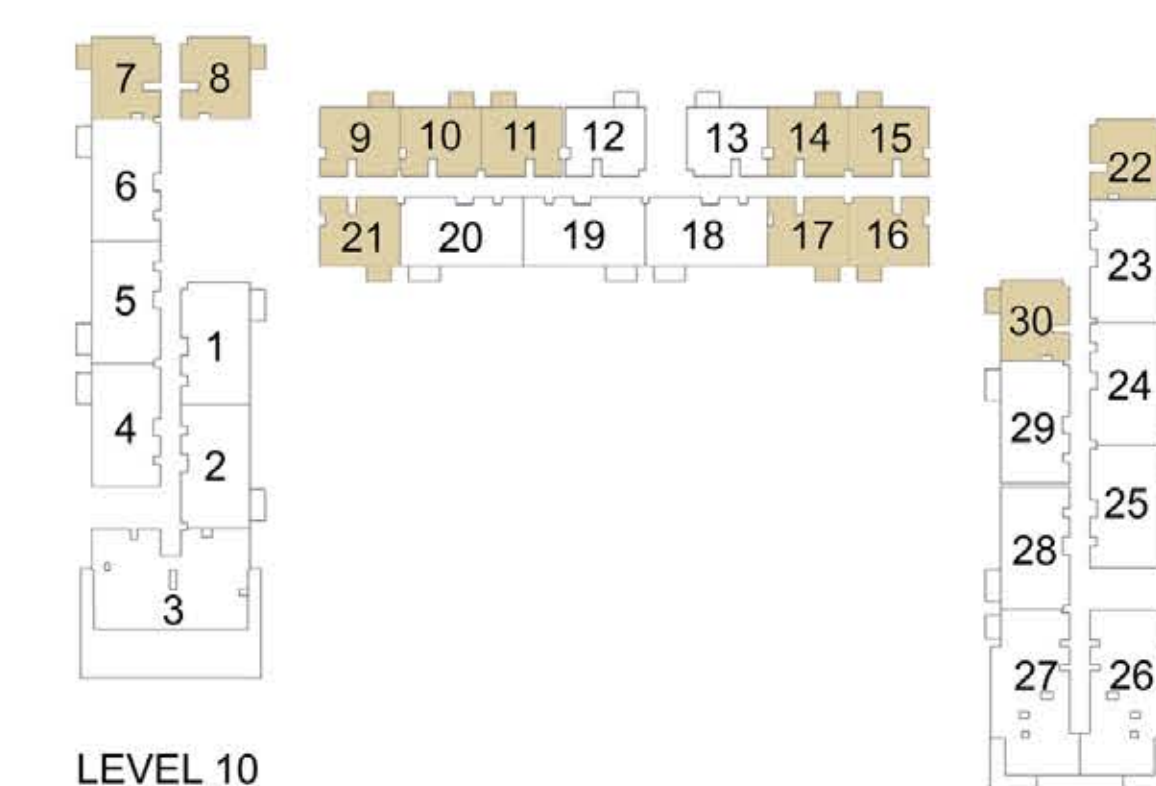

LEVEL 10

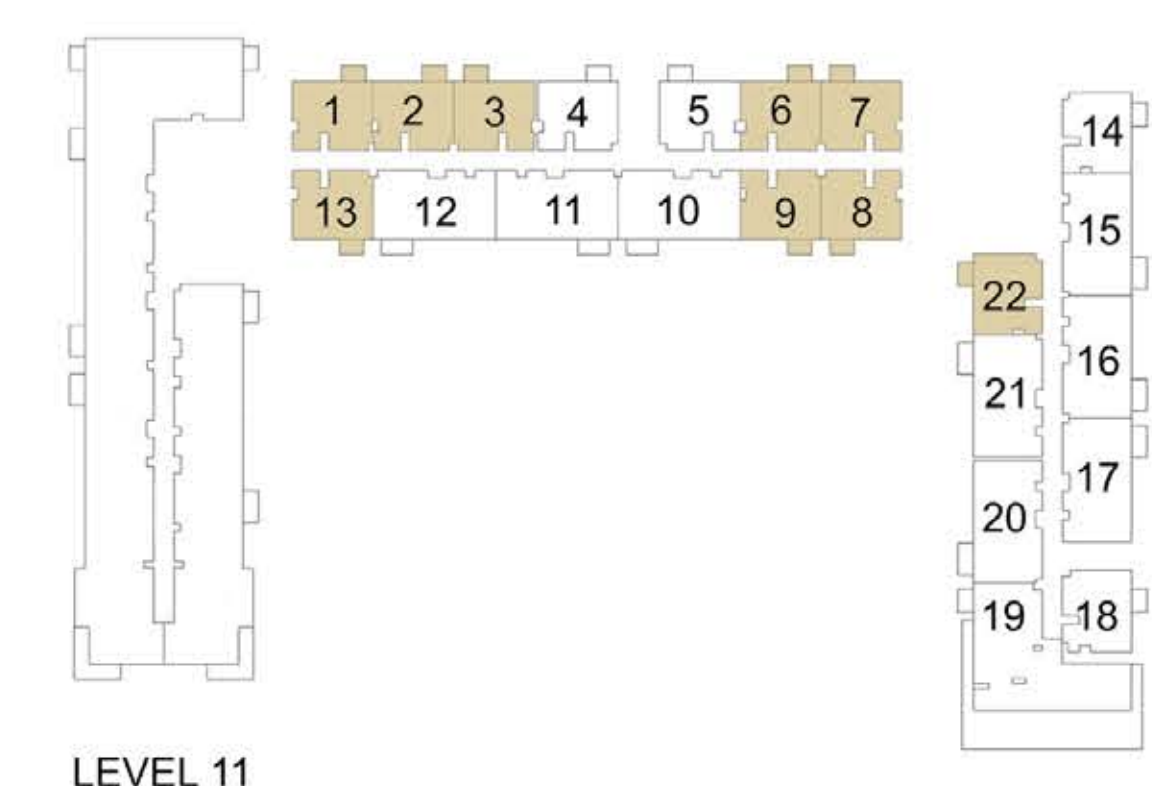

LEVEL 11

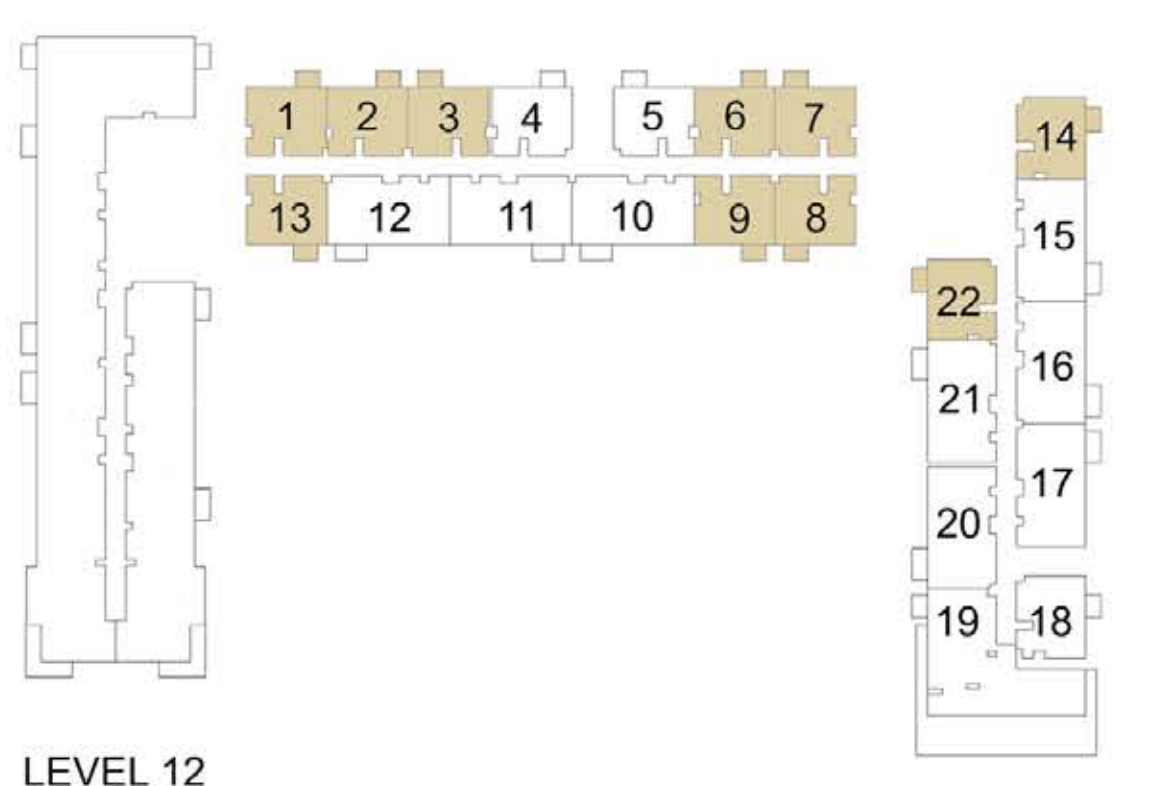

LEVEL 12

FLOOR PLAN 1. All dimensions are in imperial and metric, and measured from finish to finish excluding construction tolerances. 2. All materials, dimensions, and drawings are approximate only. 3. Information is subject to change without notice, at developer's absolute discretion. 4. Actual area may vary from the stated area. 5. Drawings not to scale. 6. All images used are for illustrative purposes only and do not represent the actual size, features, specifications, fittings, and furnishings. 7. The developer reserves the right to make revisions / alterations, at it's absolute discretion, without any liability whatsoever.